

Cooper Gulch Common Grounds

✓ Vision Statement

Cooper Gulch is a cherished community space that offers a diversity of safe, engaging recreational facilities, programs, and events for a broad spectrum of the community in balance with a healthy ecosystem.

✓ Mission

To engage the community in developing a master plan for Cooper Gulch Park.

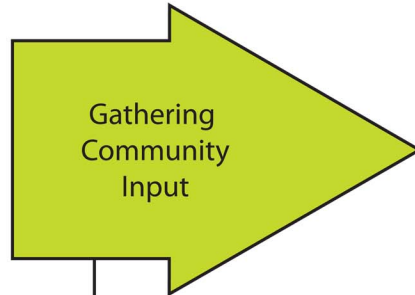
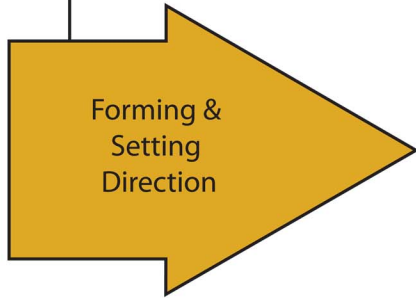

✓ Four Community Meetings

✓ Interactive Online Mapping

- ✓ 1. Draft Guiding Principles
- ✓ 2. Draft Vision Plan
- 3. Feedback on Draft Products
- 4. Integrate feedback



We
Are
Here

Request Consideration

Request consideration by City of Eureka of the CGCG Community Vision in developing a master plan for Cooper Gulch Park.

✓ > 500 Surveys completed

✓ Community Canvassing
Neighbors
Community Groups

✓ Play & Plan Day
Discussion Forums
Design Workshop
Learn by doing



Continue to Build Support

Seek partnerships
Help fundraise

Cooper Gulch Common Grounds



Draft Community Vision

Vision Statement: Cooper Gulch is a cherished community space that offers a diversity of safe, engaging recreational facilities, programs, and events for a broad spectrum of the community in balance with a healthy ecosystem.



BMX GARDENS

COOPER CREEK DAYLIGHT & CONNECTING TO WATERFRONT TRAIL

NATURE TRAIL

NEW ENTRY SIGN

FOOD TRUCK PLAZA

ENTRY PLAZA

PLAY and EXPLORE

RENEWED COMMUNITY CENTER

COMMUNITY PLAY

P STREET NEIGHBORHOOD ENTRANCE

COMMUNITY GREEN

MYRTLE GROVE CEMETERY

PERFORMANCE PLAZA

11TH STREET NEIGHBORHOOD ENTRANCE

RESTROOMS

GROVE OUTDOOR CLASSROOM

PROMENADE WALK

THE BIRDWALK

13TH STREET NEIGHBORHOOD ENTRANCE

14TH STREET ENTRANCE

LEGEND

- PROMENADE WALK
- NATURE TRAILS
- INTERPRETIVE SITES
- SHARED SPACE SIGNAGE
- FRISBEE GOLF
- NEIGHBORHOOD ENTRANCES

A Safe and Welcoming Place

Safety in the park is a primary concern of the community. Programs and facilities would be designed with an overarching goal of creating a safe and welcoming space for a diversity of users. An equitable investment of resources would be directed to improve safety in the park, while recognizing that people of different ages, abilities and backgrounds may have different safety concerns.

Entry Plaza



Entrance plaza defines entry to the park and features artistic elements and seating walls and orients visitors with a map of park. A community messaging area, dog waste bags, safety lighting and trashcan are also included.

Promenade Walk



A paved, 8 to 10 foot multi-surface ADA trail connects key park amenities and offers a 1/3 mile loop route around the field and accommodates a wide range of users— including dogs walkers. Occasional benches and art installations add places to rest and enjoy.

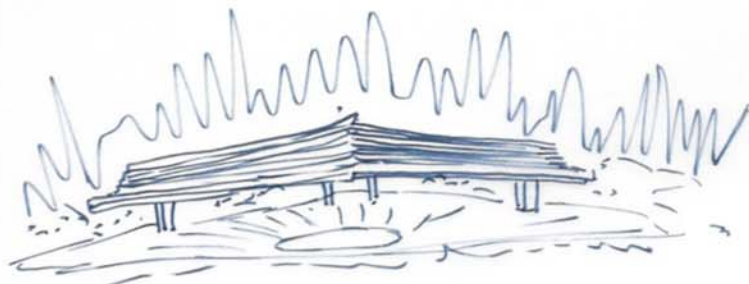

BENCH. LOCAL MADE
SCULPTURAL
HARD SURFACE DONOR PLAZA

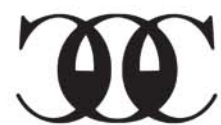

Accessible Restrooms

Restrooms are ADA accessible, open extended hours, are visibly pleasing, and do not detract from the park.

New Entry Sign



A refurbished entry sign announces the park entrance.



A Gathering Place with a Variety of Activities for a Diversity of Users

It is important that the park provide a space for community gatherings from small sized groups such as family picnics, to mid-sized gatherings for sporting events, to community wide events. The park is a critical public space that provides opportunities to share experiences and build relationships, explore our differences and strengthen our ties as a community. Providing a variety of activities increases community engagement and strengthens a sense of community ownership by a diversity of users. The park would provide opportunities for formal and informal sports, play areas and people watching places, quiet recreation, cultural opportunities such as theatrical and live music performances, and nature based experiences such as walking trails and bird viewing opportunities. Investments in the park recognize the critical value of the park as a neighborhood resource first and seek opportunities to augment these investments with visitor and tourism opportunities. Programs and activities planned in the park would seek to engage the different demographic segments of the community.



Food Truck Plaza

Replace 6-8 parking spots with grasscrete and provide power for food trucks and add picnic tables.

Play & Explore

Additional children's play area includes a water play feature, climbing logs and boulders, and picnic tables and benches. Willow fencing and structures are used to create or define nature play areas.



PLAY AREA
 • CLIMBING ROCKS, BRIDGE, SLIDES, FORT STRUCTURE, ETC
 • SEAT WALL SURROUNDS PLAZA THAT HAS WATER JETS FOR HOT DAYS BUT DOUBLES AS PLAZA



Community Play

A cluster of facilities for all ages and abilities includes bocci ball courts, benches, new ADA accessible children's play area, a pavilion area for community gatherings, exclusive rental, summer camp hub, picnic tables, and built-in bleachers for skateboard audience.

Renewed Community Center



Community center is a beautiful building that offers space for camps and classes to be hosted, is available for exclusive rental, and has open hours for community social gatherings, such as a space for seniors to play cards or a safe place for teens to meet. Area for a café and tables extends off existing community center offering views of the community green.



BMX Gardens

Explore opportunities to extend park boundary to develop a BMX pump track and gardens on city owned parcel at 7th and Myrtle Avenue.



A Gathering Place with a Variety of Activities for a Diversity of Users

Community Green



Open green accommodates two ball fields (soccer and softball), free play, performance seating, and community gatherings. Improved drainage of field extends season-of-use for organized events such as ball games, concerts, festivals, and plays. Bathouses installed around field, create habitat for bats and reduce mosquito population while offering nature learning and evening interpretative opportunities.

Performance Plaza

Equipped with power and lighting, this space provides venues for music, community performances, outdoor learning area, and space for summer camp.

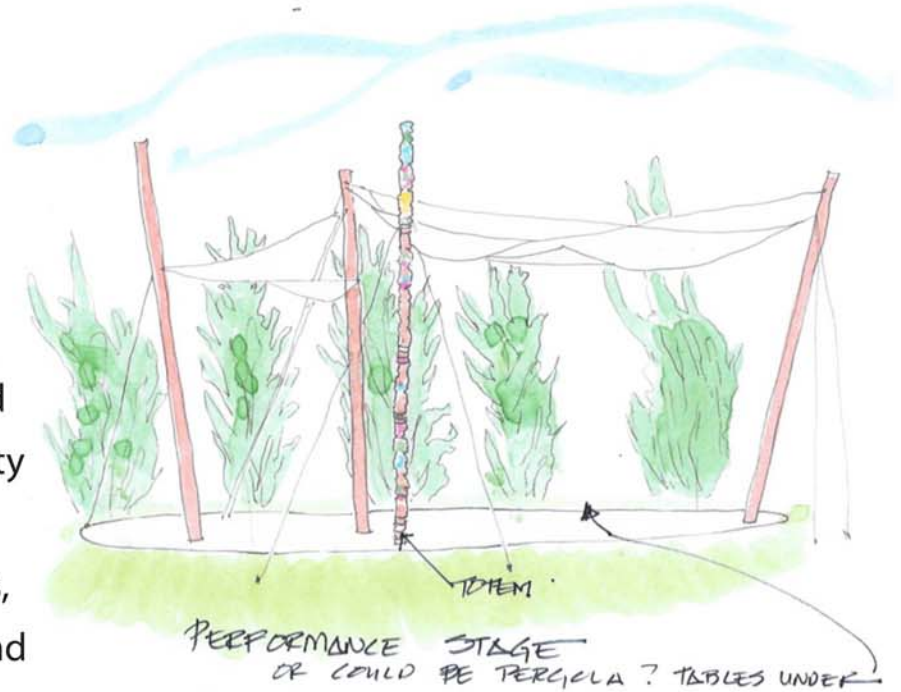

The Birdwalk

Ranging from 3-6' wide, this trail and boardwalk feature some of the park's best opportunities for bird watching and quiet recreation. Stream restoration and creek ponding feature increases habitat for aquatic birds. Blue phones along the path improve safety in remote locations.

Disc Golf & Shared Space Signage



Nine hole disc golf course aligned for minimum conflict of use, and where feasible, incorporate areas for children's nature play. Small informational sign or symbol alerts users to disc golf course and potential hazardous flying discs.



Reflects Community Values & Identity

Cooper Gulch Park reflects the community identity by offering active and safe recreational opportunities, protecting natural resources and highlight the rich cultural history of the community. It is important that park facilities are designed to be attractive and reflect the creative inspiration of Eureka and the north coast community. The natural and cultural resources of Cooper

Gulch are important aspects to the identity and enjoyment of the park. Residents and visitors value the serenity and natural feeling of the park, and want the open spaces, natural areas and experience of peaceful contemplation conserved. Restoration efforts are needed to protect and enhance the creek and riparian experience. Developments in the park build on the unique natural, geographic and cultural assets of that make Cooper Gulch Park a one-of-a-kind place.



Myrtle Grove Cemetery Restoration



The Grove Outdoor Classroom



Specimen evergreen anchors this area with added benches and nature play and learn area for children and adults. A sculptured streambank amphitheater provides a learning area for aquatic habitats.

Enhance connection between the park and cemetery. Restoration of historic pathways, headstones, mausoleums, ironwork, and vegetation based on historic photos. Interpretive opportunities are focused on the cultural heritage of the City of Eureka.

Nature Trail Walk



Ranging from 3 to 6 feet wide, these soft surface trails and boardwalks provide walking and bird-watching venues through beautiful riparian areas, with interpretive signs and benches.

Interpretive Areas

Art installations or signs highlight the rich natural and cultural history found in the park and environs.

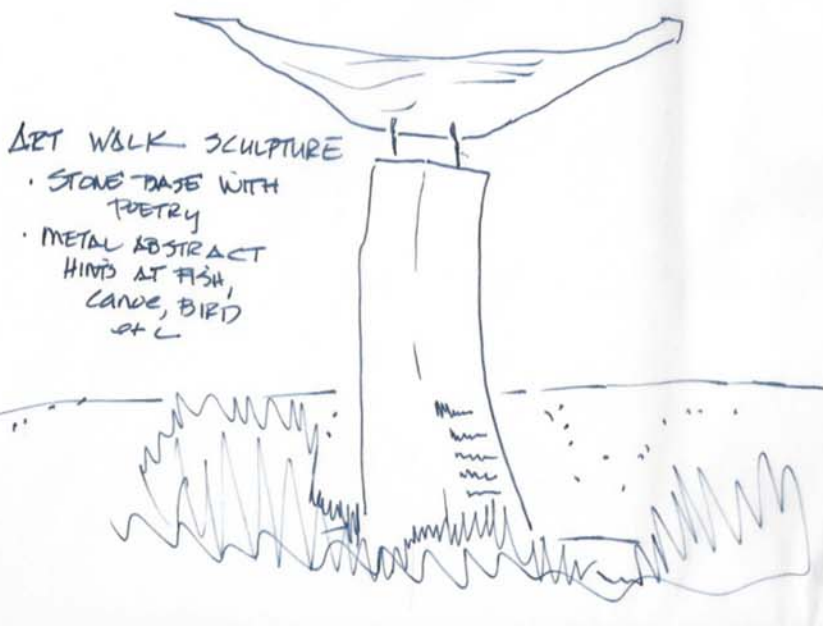

Develops Community Connections

Cooper Gulch Park is uniquely positioned to connect neighborhoods to local and regional trail systems, as well as to adjacent schools, businesses, other parks and open space. By defining and improving connections between these areas, Cooper Gulch becomes a part of the greater whole linking different community spaces. Investments in and around the park recognize and enhance these connections.

14th Street Entrances

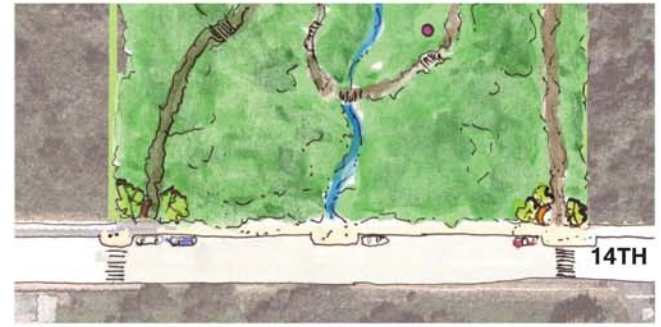

New gateways to the park welcome visitors and incorporate artistic elements, maps of the park, signage, lighting, community messaging area, dog waste bags, and waste and recycling bins. Ten to fifteen parking spots with safety bulbouts and crosswalks are located on 14th Street.

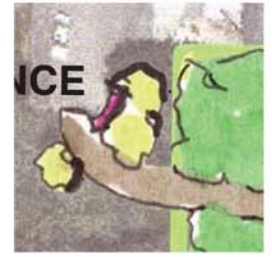
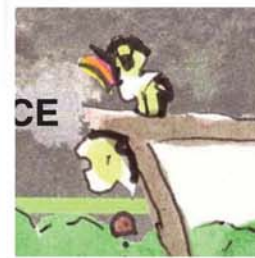

Neighborhood Entrances

Welcome sign or artistic element, map of park, low lighting, dog waste bags, and safety information orients and welcomes users to the park. Community bulletin boards are a key resource for connecting and organizing at a neighborhood scale. Information about natural resources creates greater awareness about backyard conservation and the areas natural history.

- COVERED, ILLUMINATED SIGN ARCHITECTURAL
- TRASH, DOG POOP, COOP N ENDS GATHERED TOGETHER
- DONOR PLAZA - ADOPT/BUY BRICK



- ENTRY ARCH
- PILLAR BASES INCORPORATE ART, TILES, STONES, MESSAGES, METAL...
 - METAL ARCH WITH NAME ATTACHED
 - LOW LIGHTS ON PATH
 - UPLITE ARCH



Cooper Creek Daylight & Connecting to Waterfront Trail

This area daylights and restores Cooper Creek and connects the Cooper Gulch Trail system to the Eureka Waterfront Trail.



Myrtle Avenue Passage

Signaled crosswalks provide safe passage for people to cross Myrtle Avenue at the Burre Center and the Waterfront Trail.